

STEPHANIE COLTRIN

Artistic Director
stephanie@shakespearebythesea.org

SUZANNE DEAN

Artistic Director
suzanne@shakespearebythesea.org

SONJA INGE

Administrative Assistant
sonja@shakespearebythesea.org

BOARD OF DIRECTORS

MADELEINE DRAKE

Board President
Real Estate Broker

JEWELL JONES

Board Vice-President
Retired Superior Court Commissioner

KYLE STEPHENS

Board Secretary
Northrup Grumman

SUZANNE DEAN

Board Treasurer-Interim

ANN GARTEN

Retired Public Relations/Marketing

PETER LEFEVRE

CSU, Dominguez Hills

DENCY NELSON

Retired Directors Guild of America/
Community Advocate

RAY WOLFE

Consultant, GMAC

Mission: to bring new, contemporary and classical works to underserved, culturally diverse audiences in order to ignite imagination, promote literacy and encourage artistic expression.

Shakespeare by the Sea has been enriching the lives of over 575,000 Southern California residents with **admission-free and low-cost** performances since 1998.

Non-Profit Arts Organization
ID: 95-4785457

City of Redondo Beach
Permit Division

Dear Permit Division,

Please accept this Summary of Operations for Shakespeare by the Sea/Little Fish Theatre.

Our nonprofit arts organization intends to continue offering the vital Theatre Arts programming for which we have been recognized and lauded in LA County since 1998.

As arts creators, we know that benefit of live theatre and the arts to the health and wellness of a community. They are a vital part of the social infrastructure, improving livability, civic-engagement, and contribute to healthier, longer lives of its residents.

At Beach Cities Health District, we will enrich the lives of the stakeholders on campus as well as the general public with performances throughout the year as we investigate ways to foster connections, reminding us of our shared humanity, enlightening, inspiring and engaging people who might not otherwise have access to live theatre.

We are grateful that Beach Cities Health District has this space available temporarily until we find a more permanent solution by December 31, 2026.

Thank you for accepting this Summary of Operations for our application.



Suzanne Dean & Stephanie Coltrin

Co-Artistic Directors

Mobile 310-408-7555

Web www.shakespearebythesea.org

Email suzanne@shakespearebythesea.org

Joint Email pad@shakespearebythesea.org

514 N Prospect Ave. Suite 303, Redondo Beach, CA 90277

Shakespeare by the Sea – Little Fish Theatre Summary of Operations

Shakespeare Performances:

- June – August – free touring program, out in the communities
- Flexible Daytime Office Hours for 3 Part Time staff

Little Fish Theatre:

- September - May
- Average 6-9 productions per year
- Approximately 60-90 performances
- Less than 100 Seats
- Ticketed Admission
- Performances - lasting 2-3 hours:
 - Evenings Thursday - Sunday (8pm -11pm)
 - Matinees (3 per production) Sat/Sun (2pm - 5pm)
- Rehearsals: Mon-Thurs 6pm-11pm, Sat/Sun 10am-4pm
- Flexible Daytime Office Hours for 2 Part Time Staff

Shakespeare by the Sea/Little Fish Theatre will promote health and wellness in the Community by promoting a culture of connection, delivering live shared experiences to a multigenerational audience of participants through programs such as summer Shakespeare festival, publicly open performances by Little Fish Theatre who will also offer dedicated seats for the District and its tenants to use for drama therapy, youth from allcove, older adults from Silverado Memory Care facility, etc.

APPLICATION FOR ENTERTAINMENT PERMIT

LEVEL I: \$365

LEVEL II: \$805

DEFINITIONS:

LIVE ENTERTAINMENT: Shall mean any presentation, act, reading, performance, musical rendition, or recitation, involving one or more live individuals intended to divert, amuse, explain, focus, or attract the attention of persons observing such activity. Live entertainment includes, but is not limited to: plays, musical concerts, spoken word performances, disc jockeys, MCs, hosts performance artists, magic shows, escape artists, circus acts, live animal acts, dance performances, and other, similar attractions. The term shall also encompass the provision of dancing for, or with patrons whether to live or recorded music, when Title 4, Chapter 2, Article 3 of the Redondo Beach Municipal Code does not apply to such activity.

Live entertainment shall not include: street performers; private non-commercial parties held on private property for which no admission is charged, and which are not intended to generate profit; lectures presented in fully enclosed buildings; or the use of recorded background music or television provided for the enjoyment of patrons.

EXTRAORDINARY LAW ENFORCEMENT OR PUBLIC SAFETY SERVICES: Shall mean services provided by the City of Redondo Beach which require more than two units to adequately respond to the situation, or that are beyond the course and scope of the services routinely provided to other businesses and citizens, and stretch the resources of the responding agency beyond those normally available for response.

ENTERTAINMENT PERMIT REQUIRED:

Any live entertainment conducted within the City boundaries shall require an Entertainment Permit, pursuant to Title 4, Chapter 17 of the Redondo Beach Municipal Code. Entertainment Permits approved by the City shall be posted in a highly visible location on the premises where the permitted entertainment is conducted so as to be readily inspected by representatives of the City of Redondo Beach and the general public.

EXEMPTIONS FROM PERMITTING REQUIREMENT: An Entertainment Permit shall not be required for: City sponsored activities, church or religious activities, and private or public school activities, other than commercial events occurring on church or school property. In addition, an Entertainment Permit shall not be required where: only one individual at a time will be participating in the entertainment, the sound is not amplified in any way, sound from the location does not violate the City's Noise Ordinance standards, parking for the premises meets City Code requirements, and a current Business License exists for the location. Short term events of three (3) days or less for which a Temporary Use Permit is required pursuant to Title 10, Chapter 2, Section 10-2.2520 of the Redondo Beach Municipal Code are also exempt from the requirement for an Entertainment Permit.

PERMIT TYPES:

There are two (2) types of Entertainment Permits available pursuant to Title 4, Chapter 17 of the Redondo Beach Municipal Code.

LEVEL I PERMIT: A "Level I" Entertainment Permit shall be required where: the number of persons participating in the entertainment are one (1) to three (3), the sound is amplified and/or recorded, the parking for the premises meets all City Code requirements, and a current Business License exists for the location.

LEVEL II PERMIT: A "Level II" Entertainment Permit shall be required where: the entertainment provided does not qualify for issuance of a Level I Entertainment Permit, or where the Permit Administrator has declined to process an application for a Level I Entertainment Permit as such.

INSTRUCTIONS FOR FILING:

APPLICATION FORM:

1. All Information in this application shall be typed or legibly printed.
2. Give full and complete answers to all questions.
3. If necessary, attach extra sheets to answer questions fully.
4. Applications are completed under penalty of perjury under the laws of the State of California.

APPLICATION FEE:

1. At the time of filing an application for an Entertainment Permit with the Planning Department, the required permit fee shall be paid (cash or check).
2. Checks shall be made payable to: City of Redondo Beach

APPLICATION FOR ENTERTAINMENT PERMIT

PROCEDURE FOR PROCESSING APPLICATIONS:

Upon receipt of completed applications for an Entertainment Permit, the Permit Administrator shall refer the application to the Chief of Police and Division Fire Chief for investigation, report and recommendation.

LEVEL I ENTERTAINMENT PERMITS: Decisions regarding applications for a Level I Entertainment Permit are made by the Permit Administrator. A public hearing is not required prior to a decision. At least five (5) days prior to issuing his/her decision regarding an application for a Level I Entertainment Permit, the premises upon which the entertainment activity is to occur shall be posted with a notice of the pending Entertainment Permit application. In approving a request for a Level I Entertainment Permit, the Permit Administrator may attach any conditions he/she deems appropriate to protect the health, safety, and welfare of the community and the peaceful enjoyment of all adjacent properties.

The Permit Administrator may deny an application for a Level I Entertainment Permit if it is determined that the proposed entertainment may interfere with the quiet enjoyment of neighboring properties and that there are no conditions which may be attached to an approval of the permit which would adequately ameliorate these impacts. Additionally, the Permit Administrator may decline to process an application for a Level I Entertainment Permit. Such permits shall be processed as a Level II Entertainment Permit.

APPEAL OF DECISIONS MADE BY PERMIT ADMINISTRATOR: The grant or denial of an Entertainment Permit by the Permit Administrator may be appealed to the City Manager or his/her designee. A written notice of appeal must be filed with the City Clerk within five (5) days of the date of the decision by the Permit Administrator. No notice of appeal will be deemed filed unless accompanied by the appropriate appeal fee. As soon thereafter as is reasonable possible, an administrative hearing on the appeal shall be held by the City Manager or his/her designee, pursuant to Section 10-1.2506(f)(1-3), Title 10, Chapter 2 of the Redondo Beach Municipal Code. The decision of the City Manager or his/her designee regarding the appeal shall be final.

The City Council may, by majority vote, prior to any hearing on an appeal, pre-empt the jurisdiction of the City Manager to hear the appeal and accept jurisdiction over the appeal. Such an action shall not be considered as a pre-disposition on the part of the Council majority to favor or disfavor the merits of the appeal, but a recognition that the subject matter of the appeal has sufficient importance to the community to justify the attention of governing body. Notice and hearing regarding an appeal before the City Council shall be as required by Section 10-2.2506(f)(1-3), Title 10, Chapter 2 of the Redondo Beach Municipal Code.

LEVEL II ENTERTAINMENT PERMITS: Decisions regarding applications for Level II Entertainment Permits are made by the Redondo Beach City Council, following a duly noticed public hearing, pursuant to Section 10-2.2506(f)(1-3) of Title 10, Chapter 2 of the Redondo Beach Municipal Code. After such hearing, the City Council may grant the permit subject to such conditions as it shall deem necessary to protect the health, safety, and welfare of the community, and the peaceful enjoyment of all adjacent properties.

The City Council may deny any Entertainment Permit application if it determines that the proposed entertainment may interfere with the quiet enjoyment of neighboring properties, and there are no conditions which may be attached to an approval which would adequately ameliorate these impacts.

TERM OF ENTERTAINMENT PERMITS:

LEVEL I ENTERTAINMENT PERMITS: Level I Entertainment Permit may be granted for a period of one (1) year from the date of issuance and can be renewed on the anniversary date thereof unless revoked or suspended pursuant to Section 4-17.07 of Title 4, Chapter 17 of the Redondo Beach Municipal Code.

LEVEL II ENTERTAINMENT PERMITS: Level II Entertainment Permits may be granted by the City Council for a term of up to, but not to exceed, two (2) years from the date of issuance. Existing Level II Entertainment Permits may be renewed by the Permit Administrator without a public hearing if no condition of the permit has been violated, and if less than three formal (written) complaints have been made to the City concerning the permitted activity during the previous twelve (12) month period.

SECURITY BOND REQUIRED FOR ALL LEVEL I AND LEVEL II ENTERTAINMENT PERMITS:

Every Entertainment Permit issued pursuant to Title 4, Chapter 17 of the Redondo Beach Municipal Code shall require a security bond to be posted with the City to cover extraordinary law enforcement or public safety services provided to the permit holder resulting from the entertainment activity for which the permit is granted. The bond shall consist of cash deposited with the City in a specified amount which shall be returned to the permittee upon termination of the permit. The amount of the security bond for permitted entertainment activities shall be determined pursuant to schedule adopted by resolution of the Redondo Beach City Council.

The bond required may be drawn upon when, in the determination of the Chief of Police, "extraordinary law enforcement or public safety services" have been provided to the permittee in connection with the entertainment activity conducted under an approved Entertainment Permit. The amount drawn upon shall be determined by the Chief of Police, but shall not exceed the actual and reasonable cost of providing the extraordinary service. The Chief of Police shall notify the permittee in writing of any reduction in the bond, the reason therefore, the basis for calculating the amount of the reduction and the requirement that the bond be replenished. The permittee shall have five (5) days from the date of notification to replenish the bond in the amount specified. No entertainment may be conducted by the permittee after the five (5) day notice period has occurred until the bond has been replenished pursuant to the notice. Failure to replenish the bond within the five (5) day period shall result in automatic revocation of the permit with no further action by the City necessary.

APPLICATION FOR ENTERTAINMENT PERMIT

Within five (5) days of the notice to replenish and upon replenishment of the bond, the permittee may appeal the bond reduction and replenishment requirement to the City Manager by filing a written request for appeal with the City Manager within ten (10) days from the date of the written notice. The City Manager, or his/her designee, shall hold a hearing on the appeal, pursuant to Section 4-17.06(c) of Title 4, Chapter 17 of the Redondo Beach Municipal Code. The decision of the City Manager, or his/her designee, regarding the reduction of the bond, shall be final.

NATURE OF ENTERTAINMENT PERMITS:

Entertainment Permits issued pursuant to Title 4, Chapter 17 of the Redondo Beach Municipal Code are personal to the applicant, not to the premises upon which the permitted entertainment is conducted. Permits are not transferable or assignable. No other individual may conduct entertainment under the authority of a permit issued to another.

A permit shall not be deemed transferred or assigned if the permittee is a corporation or partnership which remains under the control of the same individual or individuals who controlled it at the time the permit was approved.

Approved Entertainment Permits are granted for the specific location for which the application was submitted. Any relocation of the permitted activity, or major alteration to the existing facility, shall require a new Entertainment Permit.

CITY OF REDONDO BEACH PLANNING DIVISION

APPLICATION NO:

DATE RECEIVED:

APPLICATION FOR ENTERTAINMENT PERMIT

BE CERTAIN TO COMPLETE "PART I", "PART II" AND "PART III"

Application is hereby made to the Permit Administrator of the City of Redondo Beach, for an Entertainment Permit, Pursuant to Chapter 17, Title 4 of the Redondo Beach Municipal Code, "Amusement and Entertainment Permits".

PART I - GENERAL INFORMATION

A	APPLICANT INFORMATION		
	APPLICANT'S FULL NAME: Stephanie Coltrin / Suzanne Dean		
	APPLICANT'S MAILING ADDRESS: 514 N Prospect Ave Ste 303, Redondo Beach 90277		
	APPLICANT'S RESIDENCE ADDRESS: 939 W 29th St San Pedro, CA 90731		
	APPLICANT'S TELEPHONE NUMBERS:	Residence:	Business:
	310-346-9716 / 310-408-7555		
	APPLICANT'S DATE OF BIRTH:	PLACE OF BIRTH:	
APPLICANT'S CALIFORNIA DRIVER'S LICENSE NUMBER OR STATE IDENTIFICATION NUMBER:			

B	BUSINESS INFORMATION		
	NAME OF BUSINESS: Shakespeare by the Sea dba Little Fish Theatre		
	ADDRESS OF BUSINESS: 514 N Prospect Ave Ste L-1, Redondo Beach 90277		
	MAILING ADDRESS OF BUSINESS: 514 N Prospect Ave 3rd Floor, Redondo Beach 90277		
	TYPE OF BUSINESS: Non-profit Theatre		
	BUSINESS CONTACT (e.g. manager): Stephanie Coltrin / Suzanne Dean		
	BUSINESS TELEPHONE NUMBER: 310-512-6030		

OFFICE USE ONLY:

Application Accepted By: _____ Date: _____

Level I Permit: Level II Permit:

Referred to Police (Date): _____ Police Recommendation: Approve Deny

Referred to Fire Department (Date): _____ Fire Recommendation: Approve Deny

Action by Permit Administrator (Level I Permits): Approve Deny Approve with Conditions (attached)

Council Hearing Date (Level II Permits): _____ Council Action: Approve Deny Approve with Conditions (attached)

Bond Amount: _____ Date Bond Submitted: _____

CITY OF REDONDO BEACH PLANNING DIVISION

APPLICATION NO.

APPLICATION FOR ENTERTAINMENT PERMIT

BE CERTAIN TO COMPLETE "PART I", "PART II" AND "PART III"

PART II - SUPPLEMENTAL INFORMATION

IS, OR HAS, THE APPLICANT BEEN THE HOLDER OF AN ALCOHOLIC BEVERAGE COMMISSION LICENSE, OR AN ENTERTAINMENT PERMIT, BUSINESS LICENSE OR SIMILAR PERMIT WITHIN ANY OTHER JURISDICTION?

Yes (Where? Describe below)

No

HAS THE APPLICANT OR ANY PARTNER, CO-PARTNER, MANAGER, EMPLOYEE OR OPERATOR OF THE BUSINESS HAD AN ENTERTAINMENT PERMIT, ALCOHOLIC BEVERAGE COMMISSION LICENSE, BUSINESS LICENSE OR SIMILAR PERMIT ISSUED BY ANY JURISDICTION, SUSPENDED OR REVOKED?

Yes (Please describe circumstances of suspension or revocation below)

No

PLEASE PROVIDE THE FOLLOWING FOR ANY CO-PARTNERS, EXCLUDING LIMITED PARTNERS, OF THE APPLICANT (ATTACH EXTRA SHEETS AS NECESSARY):

1. NAME: _____ TELEPHONE: _____

BUSINESS ADDRESS: _____

RESIDENCE ADDRESS: _____

2. NAME: _____ TELEPHONE: _____

BUSINESS ADDRESS: _____

RESIDENCE ADDRESS: _____

3. NAME: _____ TELEPHONE: _____

BUSINESS ADDRESS: _____

RESIDENCE ADDRESS: _____

IF BUSINESS IS A CORPORATION, PROVIDE THE FOLLOWING FOR EACH OFFICER, DIRECTOR AND SHAREHOLDER OWNING 10% OR MORE OF THE CORPORATION. IF MORE THAN ONE CORPORATION COMPRISES THE OWNERSHIP OF THE BUSINESS, PROVIDE THE INFORMATION FOR EACH CORPORATION (ATTACH EXTRA SHEETS AS NECESSARY):

1. NAME: this is a Non-Profit Arts Organization TITLE: _____

ADDRESS: _____

2. NAME: _____ TITLE: _____

ADDRESS: _____

3. NAME: _____ TITLE: _____

ADDRESS: _____

LIST ALL TRUE AND FICTITIOUS NAMES USED BY APPLICANT WITHIN THE FIVE (5) YEARS PRECEDING THE DATE OF THIS APPLICATION:

- 1. _____
- 2. _____
- 3. _____
- 4. _____
- 5. _____
- 6. _____

CITY OF REDONDO BEACH PLANNING DIVISION

APPLICATION NO.

APPLICATION FOR ENTERTAINMENT PERMIT

BE CERTAIN TO COMPLETE "PART I", "PART II" AND "PART III"

PROVIDE THE FOLLOWING FOR EACH MANAGER AND/OR OTHER PERSON(S) IN CHARGE OF THE BUSINESS (ATTACH EXTRA SHEETS AS NECESSARY):

1. NAME: Stephanie Coltrin TELEPHONE: 310-346-9716
BUSINESS ADDRESS: 514 N Prospect Ave Ste L-1, Redondo Beach 90277
RESIDENCE ADDRESS: 939 W 29th St San Pedro, CA 90731

2. NAME: Suzanne Dean TELEPHONE: 310-408-7555
BUSINESS ADDRESS: 514 N Prospect Ave Ste L-1, Redondo Beach 90277
RESIDENCE ADDRESS: 939 W 29th St San Pedro, CA 90731

3. NAME: _____ TELEPHONE: _____
BUSINESS ADDRESS: _____
RESIDENCE ADDRESS: _____

DESCRIBE THE NATURE OF THE ENTERTAINMENT TO BE PROVIDED (INCLUDE TYPE OF ENTERTAINMENT, NUMBER OF ENTERTAINERS, INSTRUMENTS, VOCALISTS, ETC.).

Non-profit arts theatre producing professional stagings of original, classic, and contemporary plays and other small cast theatre events. Cast and event staff under 20 people. Seating configuration for up 99 audience members. (Average attendance 30 people per show.)

WILL ENTERTAINMENT BE AMPLIFIED? IF SO, DESCRIBE THE NATURE OF THE USE AND THE TYPE OF AMPLIFICATION TO BE USED.

Amplified sound (effects and music) typical for an under 99-seat small theatre.

DESCRIBE THE DATE OR DATES AND/OR DAYS OF THE WEEK ON, AND HOURS AT WHICH THE ENTERTAINMENT IS TO BE PROVIDED, INCLUDING THE ADMISSION FEE (IF ANY), COVER CHARGE (IF ANY) AND DONATION, INCLUDING DRINK MINIMUMS (IF ANY) TO BE SOLICITED FOR SUCH PERFORMANCE.

Typically schedule Thurs - Sat Nights - 8pm shows, occassional Saturday and Sunday - 2pm Matinees. Producing a year-round season of events - typically 8 production a year that run for 3 weekends each.

Single admissions and subscription packages are sold. Single Admission Tickets range \$10-\$35, \$50-\$75 for special events. Multi Ticket Subscriptions (\$165-\$275 for 6-10 tickets). Complimentary admissions extended to other non-profits and under-served audiences.

Concessions are available on a "suggested donation" basis. As a non-profit theatre, donations are solicited to support the programming, wages, and overhead.

CITY OF REDONDO BEACH PLANNING DIVISION

APPLICATION NO.

APPLICATION FOR ENTERTAINMENT PERMIT

BE CERTAIN TO COMPLETE "PART I", "PART II" AND "PART III"

PROVIDE THE FOLLOWING INFORMATION FOR THE OWNER OF THE PREMISES UPON WHICH THE BUSINESS IS LOCATED

NAME: Beach Cities Health District TELEPHONE: (310) 374-3426
BUSINESS ADDRESS: 1200 Del Amo Blvd, Redondo Beach, CA 90277
RESIDENCE ADDRESS: _____

Please provide the following supplemental information which will be used by the Permit Administrator, Chief of Police, Fire Division Chief, and City Council (where required) in evaluating your application for an Entertainment Permit. The Permit Administrator may request other information than that described herein, if deemed necessary to permit a full evaluation of your application. Attach separate sheets as necessary, labeling each attachment in a manner which corresponds to the item number listed below):

- A. **Scaled and dimensioned diagram showing the floor plan for the building occupied by the business and the location of the performance area on the premises, with all seating and a list of equipment and/or instruments to be used in the performance.**
- B. **Written and signed authorization from the property owner/property management authorizing the business to provide live entertainment and submit this application to the City of Redondo Beach.**

If applying for a Level 2 Entertainment Permit, provide the following additional items:

- A. **Description of the nature, name and place of the applicant's business or employment during the five (5) years immediately preceding the date of the application for an Entertainment Permit. A resume will suffice.**
- B. **2-inch square photograph of the applicant taken within sixty (60) days immediately prior to the date of application for an Entertainment Permit.**
- C. **Live Scan will be required of the applicant, owner or principal manager of the business. Live Scan form will given to the applicant at time of application submittal.**

CITY OF REDONDO BEACH PLANNING DIVISION

APPLICATION NO:

APPLICATION FOR ENTERTAINMENT PERMIT

BE CERTAIN TO COMPLETE "PART I", "PART II" AND "PART III"

PART III - DECLARATION

The following Declaration shall be signed in the presence of a Notary Public within and for the State of California.

If the applicant or business is a corporation or partnership, this declaration shall be signed by that individual assigned responsibility for signing legal documents on behalf of said corporation or partnership.

I, Stephanie Coltrin, Suzanne Dean, being duly sworn, hereby certify under penalty of perjury that the foregoing statements and information presented within the attached application for an Entertainment Permit are, in all respects, true and correct to the best of my knowledge and belief.

Additionally, I understand and accept that the information provided within the attached application will be reviewed by the Redondo Beach Police Department and Fire Department prior to final approval of the requested permit.

Handwritten signatures of Stephanie Coltrin and Suzanne Dean.

Applicant Signature

CoArtistic Directors

Title/Position

514 N Prospect Ave

Address

Redondo Beach CA 90277

310-346-9716 / 310-408-7555

Telephone Number

Attach a Jurat Form prepared by a Notary Public



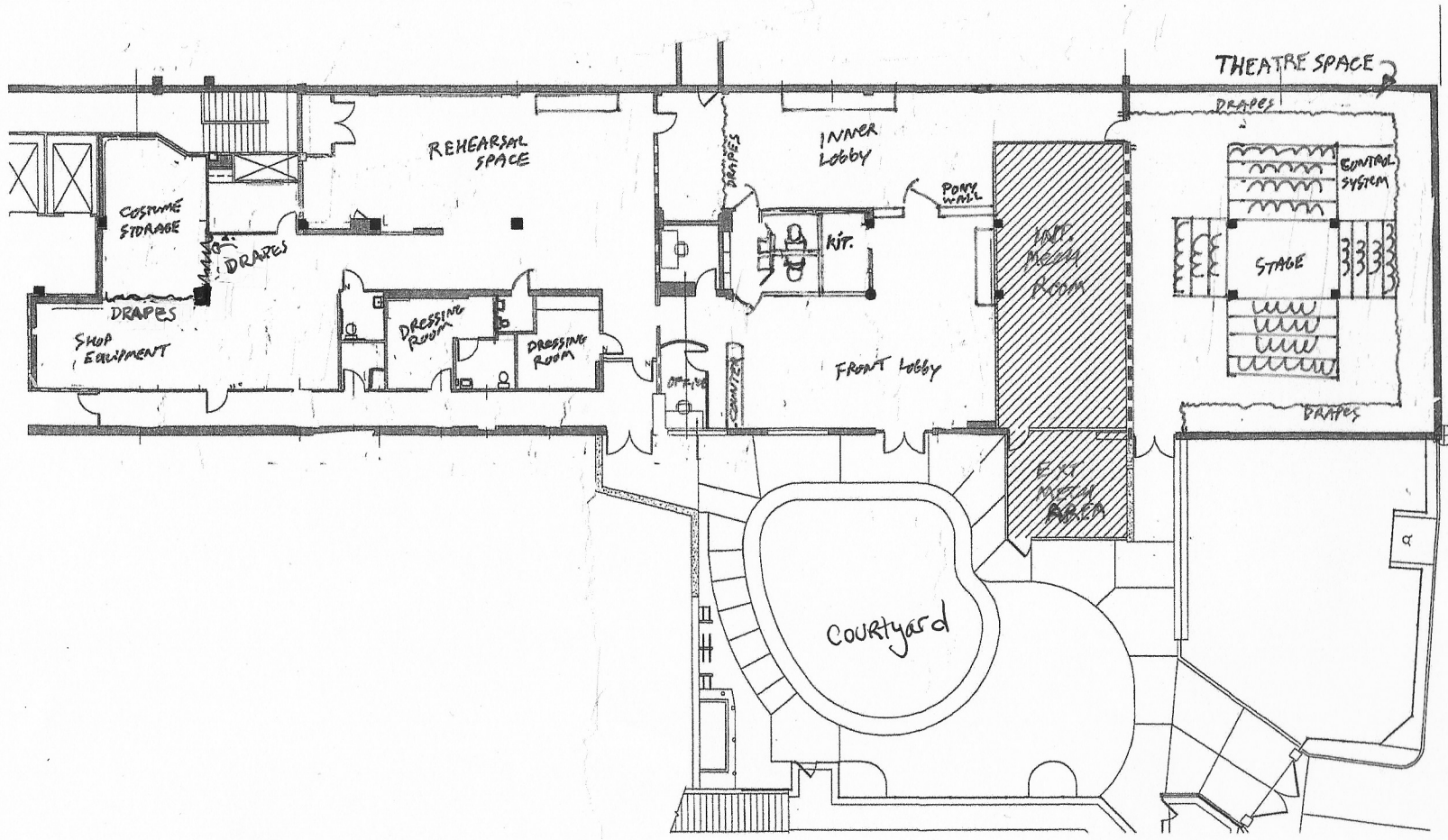

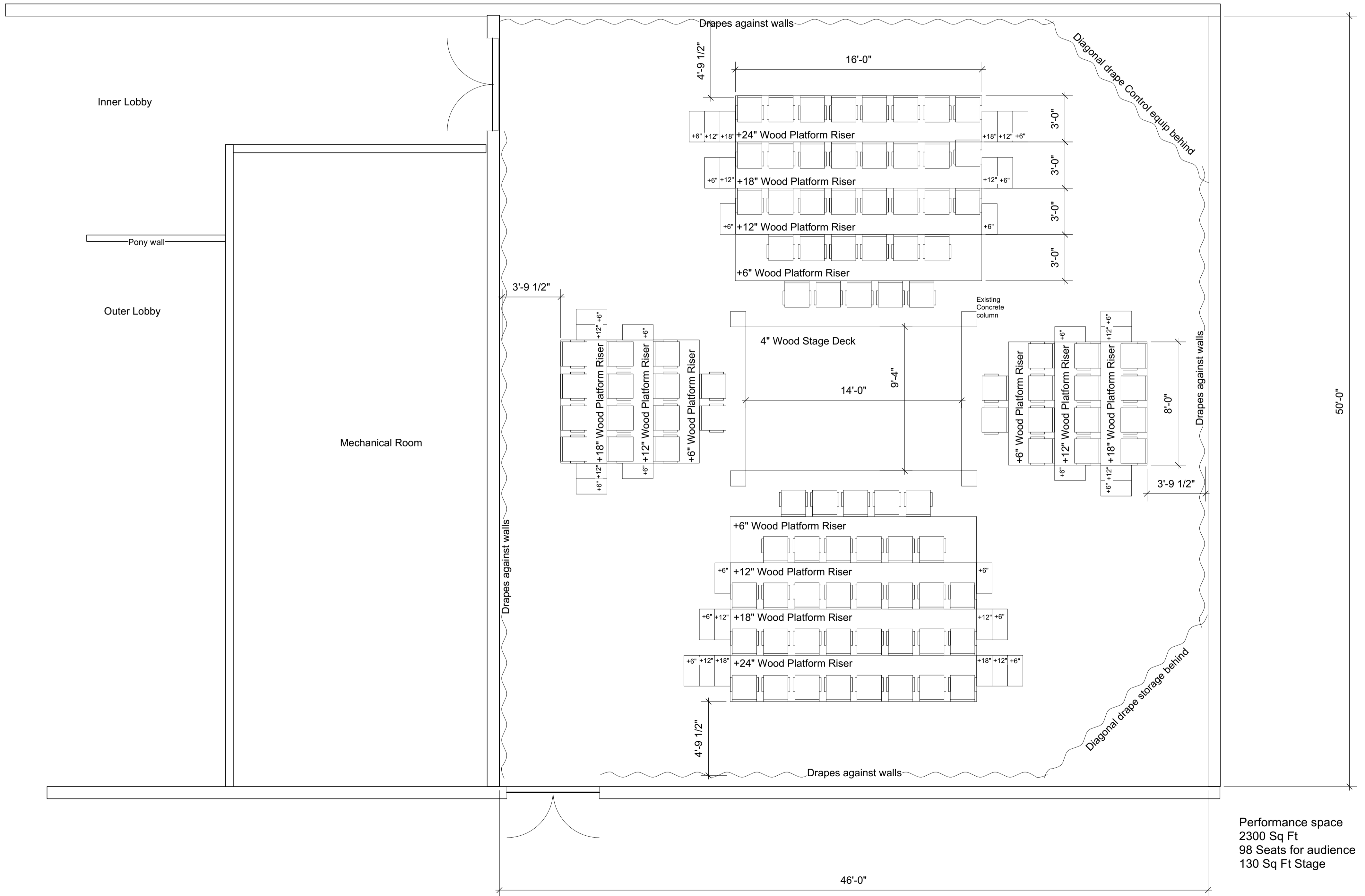

Performance space
 2300 Sq Ft
 98 Seats for audience
 130 Sq Ft Stage



Lighting Inventory

Instrument	QTY	DIMMERS	QTY
Par Edison	11	Edison	3
Par 3-Pin	3	Stage Pin	2
Min-Par Edison	5		
Mini-Par 3-Pin	7	5 are 6-channel, 1 is 3-channel	
Fresnel Edison	3	Plus 2 dead channels = 3 channels	
Fresnel 3-Pin	4		
Source 4 Edison	2		
Source 4 3-Pin	1		
Parnell Edison	4		
LED Tri 18X	4		
LED Tri 17X	2		
Barndoors	4		
Ellipsoidal 6x9 Edison	3		
Ellipsoidal 6x9 3-Pin	1		
Leko 3-Pin	1		
Luma Powered Super Strobe	1		

DMX Cables

DMX 3 PIN	
50 ft	4
25 ft	2
5 ft	4
DMX 6 PIN	
25 ft	3
5 ft	4
5 Pin Male to 3-Pin Female Adapter	1
3 Pin Terminator	1

Stage Pin/Edison Cables

Length	Stage Pin	Edison
5	4	2
8		4
10	7	1
12		6
15		4
20		
25	8	2
30		1
50	1	4
100		4

Sound equipment

2 speakers

1 amplifier

1 processor

Mixing board

Sound run via 2nd laptop

A. Description of the nature, name and place of the applicant's business or employment during the five (5) years immediately preceding the date of the application for an Entertainment Permit. A resume will suffice.

Business: **Shakespeare by the Sea dba Little Fish Theatre**

Founded in 1998, Incorporated 2000

Non-profit ID **95-4785457**

Nature of Business: **Non-profit Arts Org / Entertainment Theatre Venue**

Former Location Address: **777 S Centre Street San Pedro, CA 90731**

Years of Business Operation at former address San Pedro: **2002-2024**

Website for Little Fish Theatre: <https://www.littlefishtheatre.org/pond/>

Attached history of programming

PRODUCER'S HISTORY

Shakespeare by the Sea (SBTS) is an established arts organization that has been operating in LA County since 1998 when it began producing a free Summer Shakespeare Festival that currently tours to over 15 communities and contemporary works in a fixed location indoor theatre.

In 2002, the company transformed an old city tow yard into an intimate 65 seat performance venue called **Little Fish Theatre (LFT)** to produce theatre year-round and is designated a Membership Company by Actor's Equity Association. While both programs provide impactful theater, LFT focuses on new and contemporary works that lend themselves to an intimate theatre venue. A LFT season includes over a dozen productions - full length plays, short form projects, and solo shows that include theatre artists from throughout the LA region.

In 2023, LFT produced 8 full run productions and 5 short run events for a total of 72 performances. LFT seasonally employed 63 professional actors and another 72 creative and technical personnel. There are 4 year-round employees.

Relocation - Last winter, after 21 years located in San Pedro, the organization lost the lease to the theatre venue to commercial re-development. The 2024 season (22nd year for LFT) was paused for a region-wide search to find a new venue. In March 2024, SBTS/LFT moved its entire operation Beach Cities Health District. Leaning on past experience transforming non-traditional spaces, we are currently Transforming the space into a professional theatre for LFT, with attached rehearsal hall, scenic shop, multiple dressing rooms, exhibit areas, and a large lobby and courtyard for entertaining. In Winter 24, LFT plans to resume productions and reopen to the public.

The new venue in Redondo Beach allows SBTS/LFT to continue its established entertainment programming for the public as well as expand into social and educational programming by engaging with some BCHD neighbors - allcove Beach Cities and their families and the residents, healthcare workers, and families of Silverado. This move is a new chapter, and an extension in our efforts to find ways to engage people who would not usually access theatre. With a 27th Season of Shakespeare on tour this summer and a full season planned at LFT in 2025, SBTS/LFT has renewed its mission to not only produce great plays but also make a positive impact in local community.

Leadership - SBTS/LFT Co-Artistic Directors Stephanie Coltrin and Suzanne Dean share over 40 years between them of experience in producing theater, developing new works, operating a venue, fundraising, theatre arts education and supporting creative and technical artists.

LFT History of Programming

2024 Season

- Pick of the Vine: Season 22
- Feb 2024 - Theatre closed for Relocation to Redondo Beach**

2023 Season

- Pick of the Vine: Season 21
- Mandy Picks a Husband
- All in the Timing
- Jane Austen in 48 Minutes (**World Premiere**)
- Di Lady Di
- Queen of Fishtown
- You Can't Take It With You (Reading)
- Cabaret Night
- Vanya and Sonja and Masha and Spike
- Seminar
- Chills and Thrills
- Meteor Shower
- On the Farce Night of Christmas (**West Coast Premiere**)

2022 Season

- Pick of the Vine: Season 20
- The Revolutionists
- The Other Place
- Eurydice
- Henry VI Part 2 (with SBTS)
- Last Dance
- A Moment (**World Premiere**)

2021 – Theatre remained closed to the public by pandemic

- Virtual Stage – Pick of the Vine: Season 19
- Virtual Stage – Loves Me, Loves Me Not
- Virtual Stage – Pygmalion
- Virtual Stage – Bleacher Bums (Reading)
- Virtual Stage – Big Laughs with Brian O'Sullivan
- Virtual Stage – Reading of the Will Mystery
- Chills and Thrills

2020 Season

- Pick of the Vine: Season 18
- Loves Me, Loves Me Not
- Dead Man's Cell Phone
- In March 2020, LA County ordered the closing of Theatres, LFT produced virtual theatre while the physical building stayed closed to the public.**
- Virtual Stage – Little Fish Web Series (6 parts)
- Virtual Stage – Half Life (Reading)
- Virtual Stage – 3 Couples (Reading)
- Virtual Stage – Days of Possibilities (Reading)
- Virtual Stage – Home Fires Burning (Reading)
- Virtual Stage – Trees of Knowledge (Reading)
- Virtual Stage – MASH (Reading)
- Virtual Stage – Romeo & Juliet Choose Your Own Ending
- Virtual Stage – Pick of the Pine

2019 Season

- Pick of the Vine: Season 17
- Loves Me, Loves Me Not
- Improv Night
- Beer Night
- Uncle Vanya Reading
- The Cemetery Club
- The Country House
- Dead Accounts
- Cabaret Night
- The Nerd
- The Lonesome West
- Operation Ajax (**LA Premiere**)
- Chills & Thrills
- Embridge (**World Premiere**)

2018 Season

- Pick of the Vine: Season 16
- Quartet
- The Balcony Scene
- Mending Fences
- Provenance
- The Foreigner
- Plaza Suite
- Sea Marks

- On Clover Road
- Bloody Poetry
- A Christmas Cactus

2017 Season

- Pick of the Vine: Season 15
- Laughter on the 23rd Floor
- Dinner with Friends
- Improv Night at LFT
- Boeing Boeing
- Dear Master (**LA Premiere**)
- The Good Doctor
- Best of Pick of the Vine
- On The Verge
- The Night Before The Night Before Christmas

2016 Season

- Pick of the Vine: Season 14
- Domestic Tranquility (**West Coast Premiere**)
- Sleuth
- Table Manners
- The 39 Steps
- The Clean House
- Rapture, Blister, Burn
- The How and The Why
- The Ithaca Ladies Read Medea (**World Premiere**)
- What the Night is For
- A Very Special Holiday Special

2015 Season

- Pick of the Vine: Season 13
- Taking Sides
- The Ladies Foursome
- Oh, Baby!
- The Doll
- Private Lives
- And the Stones Will Cry Out (**World Premiere**)
- Someone Who'll Watch Over me
- Henry IV, Part 1
- Private Eyes
- Ethan Claymore

2014 Season

- Pick of the Vine: Season 12
- Melville Boys

- *Underneath the Lintel*
- *The Gin Game*
- *Central Park West*
- *Mama Won't Fly*
- *Time Stands Still*
- *Oswald: the actual interrogation (LA Premiere)*
- *Ghost in the Meadow*
- *Educating Rita*
- *Bus Stop*

2013 Season

- *Pick of the Vine: Season 11*
- *Chapter Two*
- *See Rock City*
- *Looking*
- *Embraceable Me*
- *Steel Magnolias*
- *Kitchen Witches*
- *Rounding Third*
- *The Weir*
- *Grace & Glorie*
- *Every Christmas Ever Told...And Then Some*

2012 Season

- *Pick of the Vine: Season 10*
- *Spit Like a Big Girl*
- *The Love List*
- *Marriage is Murder*
- *Panache*
- *'Night Mother*
- *Real Estate*
- *Beyond Therapy*
- *No Exit*
- *Bach at Leipzig*
- *Last Train to Nibroc*
- *Present Laughter*

2011 Season

- *Pick of the Vine: Season 9*
- *Sugar Bean Sisters*
- *My Wife's Husband*
- *Italian American Reconciliation*
- *Stones in His Pockets*
- *Old Love*
- *A Southern Exposure*
- *Tryst*
- *Twisted, Spooky, Creepy*
- *Loot*
- *Hallelujah Girls*

2010 Season

- *Pick of the Vine: Season 8*
- *Escanaba in Love*
- *Escanaba in da Moonlight*
- *Tooth and Nail*
- *Fully Committed*
- *Dixie Swim Club*
- *The Foursome*
- *Hedda Gabler*
- *Seven at West 70th*
- *And to All a Goodnight*

2009 Season

- *Pick of the Vine: Season 7*
- *Escanaba in da Moonlight*
- *13 O'Clock*
- *Hay Fever*
- *Betrayal*
- *What the Butler Saw*
- *Underneath the Lintel*
- *Deathtrap*
- *Hate Mail*
- *Scrooge's Really Really Bad Night*

2008 Season

- *Pick of the Vine: Season 6*
- *The Lion in Winter*
- *Crimes of the Heart*
- *School for Scandal*
- *Wonder of the World*
- *It's a Wonderful Life: A Live Radio Show*

2007 Season

- *Pick of the Vine: Season 5*
- *Token Cracker*
- *String of Pearls*
- *Wacky Wednesdays*
- *The Underpants*
- *Arms & The Man*
- *Veronica's Room*
- *It's a Wonderful Life: A Live Radio Show*

2006 Season

- *Pick of the Vine: Season 4*
- *Time is a Gentleman*
- *The Beauty Queen of Leenane*
- *The Importance of Being Earnest*
- *The View From Anderson Park (World Premiere)*

- *It's a Wonderful Life: A Live Radio Show*

2005 Season

- *Pick of the Vine: Season 3*
- *I'm Not Rappaport*
- *A Coupla White Chicks Sitting Around Talking*
- *The Misanthrope*
- *Collected Stories*
- *Frankie & Johnny*

2004 Season

- *Pick of the Vine: Season 2*
- *Peg & Garrick (World Premiere)*
- *Oleanna*
- *Tennessee's Women*
- *Inside My Father's Apple Tree (World Premiere)*
- *Tow Yard Dreams*
- *A Charles Dickens Christmas*

2003 Season

- *The Owl & The Pussycat*
- *Barefoot in the Park*
- *Taming of the Shrew*
- *The Lucky Spot*
- *Blithe Spirit*
- *Desdemona: A Play about a Handkerchief*
- *A Charles Dickens Christmas*

2002 Season

- *A Coupla White Chicks Sitting Around Talking*
- *Castles in the Air*
- *The Complete Works of William Shakespeare...Abridged*
- *Dark Doings at the Crossroads or Who Stole the Salad Dressing?*
- *Lone Star and Laundry & Bourbon*
- *The Illusion*
- *The Lady's Not for Burning*
- *Random Picks (POV #1)*

**FIRST AMENDMENT TO
REAL ESTATE LEASE
COMMERCIAL GROSS LEASE**

THIS FIRST AMENDMENT TO LEASE ("Amendment") is dated __February 20__, 2024 (the "Amendment Date"), and entered into by and between Beach Cities Health District ("Lessor") and Shakespeare by the Sea d/b/a Little Fish Theatre, a California nonprofit public benefit corporation ("Lessee") (hereinafter referred as the "Parties" collectively or a "Party" individually).

BACKGROUND

A. **WHEREAS**, Lessor and Lessee are parties to that certain Lease Agreement dated February 20, 2024 (the "Original Lease"),

B. **WHEREAS**, Lessor is a Government Local District and operates a Community Wellness and Medical Office Building open to the public at 514 N. Prospect Ave., Redondo Beach, CA 90277.

C. **WHEREAS**, Lessor and Lessee have agreed to establish the Lessee offices on the 3rd floor at 514 N. Prospect Ave., Redondo Beach, CA 90277.

D. **WHEREAS**, The Lessee intends to apply for an entertainment permit with the City of Redondo Beach to have public performances in Suite L1 at 514 N. Prospect Ave., Redondo Beach, CA 90277.

E. **WHEREAS**, The Lessor will allow the Lessee to use the District Suite L1 to prepare, stage-build, rehearse, etc. for public performances and any other related uses, for any other purposes consistent with the use made by other tenants in the Building, for any use permitted by law or for any other purpose for which Landlord gives its reasonable consent.

NOW THEREFORE, Lessor and Lessee, intending to be legally bound, agree to the following modifications to the Lease.

AGREEMENT

1. **Defined Terms.** All capitalized terms used herein but not specifically defined in this Amendment shall have the meanings ascribed to such terms in the original Lease.
2. **Recitals.** The recitals set forth above are hereby incorporated by reference and made a part of this Amendment.
3. **Premises. Paragraph 1.1** is changed to read:
The Premises consist of approximately 260 rentable square feet known as Suite 303 on the 3rd floor of the Building (as defined in Section 1.2 of "Original Lease"), which is further described on the floor plan attached hereto as Exhibit B (the "Premises"). The address of the Premises is 514 N. Prospect Avenue, Redondo Beach, CA 90277.
4. **Existing Lease; Entire Agreement.** Except as expressly modified by this Amendment, the terms and conditions of the Original Lease and Subsequent Addendums and Amendments, if any, remain unchanged and in full force and effect. The Lease, as modified by this Amendment, constitutes the entire agreement between Lessor and Lessee and supersedes all prior and contemporaneous agreements and understandings of Lessor and Lessee in connection therewith.

IN WITNESS WHEREOF, the Parties have duly executed this Amendment effective as of the Amendment Date.

Lessor:
Beach Cities Health District

BY:  Signed: 5/9/2024

PRINT NAME: Tom Bakaly

PRINT TITLE: CEO

DATE SIGNED: _____, 2024

Lessee:
Shakespeare by the Sea d/b/a Little Fish Theatre

BY: 

PRINT NAME: Suzanne Dean

PRINT TITLE: Co-Artistic Director

DATE SIGNED: May 08, 2024

EXHIBIT B

3rd FLOOR
FLOOR PLAN



Record of Signing

For
Name
Title



Signed on 2024-05-09 17:59:26 GMT

Secured by Concord™
DocumentID: 02wVkzdeqfM4YN5A14I6t
SigningID: 02wVkzdeknx5sp44Dezgg8
Signing date: 5/9/2024
IP Address: 72.34.99.2
Email: tom.bakaly@bchd.org



Signed with www.concordnow.com