



Southern California Edison Company

505 MAPLE AVENUE  
TORRANCE CA 90503

REDONDO BEACH, CITY OF  
415 DIAMOND ST  
REDONDO BEACH CA 90277

Document #	7590561385
Invoice Date:	06/21/2024
SCE Contact:	Amanda Gayle McEvoy
Telephone:	(310)-783-9303
Install - Billing Option:	SCE INSTALL -

Description	Amount
Service Request Number: 3738317 Project:  2506 MANHATTAN BEACH BLVD U PED REDONDO BEACH CA 90278  Invoice # 549242	
Item # 580895 Product: 2275740 - NEW METER & SERVICE Design #: 1740884	\$1,306.32
Previous Payment <b>COMMENTS:</b> * For Mixed-Fuel projects, payment and signed contracts MUST be received before July 1, 2024, to keep subsidies (allowances, discount/refund options) and estimated cost pricing, otherwise SCE will reprice the project WITHOUT subsidies. * Effective July 1, 2024, through December 31, 2024, Mixed-Fuel new construction projects (gas or propane in addition to electricity) will not receive subsidies and will be priced as estimated cost. * Effective January 1, 2025, Mixed-Fuel new construction projects will not receive subsidies and will be priced as actual cost billing. * Enclosed are two copies of your invoice. Please return one copy of the invoice with your payment to Accounts Receivable in the enclosed return-addressed envelope. The other copy of the invoice is for your records. * All payments must be delivered by mail, an alternate postal method, or one of our electronic payment options. Walk-in payments are no longer accepted at any SCE location, including Accounts Receivable. * Call the Edison company at 1-800-655-4555 to make application for electrical service. * An Edison Inspector must approve all underground systems. Please call your designated inspector 48 hours prior to construction to schedule an inspection. * Final electrical inspection from the local governmental building and safety department must be received before we can energize your service. * By paying this invoice, customer acknowledges and agrees that if this project is canceled by customer for any reason or customer does not proceed with the project completion. * Any expense incurred by SCE, including, but not limited to, expenses related to engineering, inspection and construction, prior to the project cancellation or completion will be deducted from any applicable refund due to the customer. * To ensure worker and public safety, please maintain the appropriate clearance distance from utility infrastructure during your construction project to avoid encroachments that may result in serious injury or damage. * If relocation of existing utility infrastructure is pending, please adjust your work around the proposed relocation schedule as appropriate. If you have any questions, please contact the designated SCE representative assigned to your project. .	\$0.00

TOTAL PROJECT INVOICE AMOUNT:

\$ 1,306.32



SOUTHERN CALIFORNIA  
**EDISON**<sup>®</sup>

An **EDISON INTERNATIONAL**<sup>®</sup> Company

Southern California Edison Company

505 MAPLE AVENUE

TORRANCE CA 90503

REDONDO BEACH, CITY OF

415 DIAMOND ST

REDONDO BEACH CA 90277

Document #	7590561385
------------	------------

Invoice Date:	06/21/2024
---------------	------------

SCE Contact:	Amanda Gayle McEvoy
--------------	---------------------

Telephone:	(310)-783-9303
------------	----------------

Install - Billing Option:	SCE INSTALL -
---------------------------	---------------

Description	Amount
Service Request Number: 3738317 Project:  2506 MANHATTAN BEACH BLVD U PED REDONDO BEACH CA 90278	Invoice # 549242

**ADDITIONAL PAYMENT INSTRUCTIONS:**

**If paying by check, please follow instructions on payment stub**

**Instructions for wire or ACH payments:**

JP Morgan Chase Bank  
New York, NY  
ABA#: 021000021 - Acct#: 323-394434  
SCE Taxpayer ID No. 95-1240335  
SCE Contact: Amanda Gayle McEvoy  
Document #: 7590561385

**\*\*\* Failure to properly identify your document number and SCE contact may delay the application of funds and initiation of your project**

**Special Instructions for overnight delivery methods:**

Southern California Edison  
Attn: Remittance Processing  
G.O. 1 Ground Floor, Room G53  
2244 Walnut Grove Ave.  
Rosemead, CA 91770

Please detach and return payment stub with payment

**Payment  
Stub**

Please pay total amount now due:



\$ 1,306.32

Document # 7590561385

REDONDO BEACH, CITY OF  
415 DIAMOND ST  
REDONDO BEACH CA 90277

Thank you for paying promptly  
Make check payable to Southern California Edison

ATTN: Remittance Processing  
PO Box 800  
Rosemead, CA 91771-001

**SOUTHERN CALIFORNIA EDISON ( "SCE " )  
DISTRIBUTION LINE AND/OR SERVICE EXTENSION  
APPLICANT'S INSTALLATION OPTION AND  
STATEMENT OF APPLICANT'S CONTRACT ANTICIPATED COSTS**

Applicant : REDONDO BEACH, CITY OF

Product Number : 2275740

Project Specific Location : 2506 MANHATTAN BEACH BLVD CA 90278

**1. INSTALLATION OPTIONS**

Applicant understands that in accordance with SCE's Rule 15 and/or Rule 16, Applicant can elect to have either SCE install the Distribution Line and/or Service Extension or a Qualified Contractor/Subcontractor install the Distribution Line and/or Service Extension.

**2. SCE'S ESTIMATED REFUNDABLE COST INFORMATION**

SCE's estimated refundable costs are based on the work that SCE would normally perform that can be performed by a Qualified Contractor/Subcontractor under the provisions of the Applicant Installation Option, Rule 15, Section G, and in accordance with SCE's Terms and Conditions Agreement for Installation of Distribution Line Extension by Applicant (Form 14-188).

SCE's estimated refundable costs:\* \$0.00

If applicable, other estimated cost information may be provided below. This could include the credit amount for Rule 16, street light, or other associated installation work.

SCE Rule 16 credit amount :\* \$763.61

SCE street light credit amount :\* \$0.00

SCE associated work credit amount :\* \$0.00

**3. APPLICANT SELECTION**

Applicant understands the installation options under Section 1 above, and hereby elects the following installation option by **initialing** the appropriate selection below:

           Installation by SCE  
           Installation by Qualified Contractor/Subcontractor

Under installation by Qualified Contractor/Subcontractor, Applicant shall secure project specific bid information from Qualified Contractors/Subcontractors for the installation of the Distribution Line and/or Service extension. Applicant shall contribute or advance before the start of construction any refundable or non-refundable amounts as specified in Rules 15 and 16.

\*Please refer to the specific contract, Appendix A, for detailed financial information.

**4. APPLICANT'S CONTRACT ANTICIPATED COST INFORMATION** (to be completed only if installation is performed by a Qualified Contractor/Subcontractor as selected in Section 3 above)

Applicant and/or Applicant's Qualified Contractor/Subcontractor understands that for the portion of the Electrical Distribution and/or Service Extension that SCE would normally install, in accordance with SCE's Rule's 15 and/or 16 and the Terms and Conditions Agreement for Installation of Distribution Line Extension by Applicant, the Applicant, prior to performing any work associated with the installation of these electrical facilities, and for the purpose of utility billing and accounting, shall elect one of the following options, and return this form to SCE prior to SCE proceeding with any further work on the Applicant's project.

Option 1 Applicant elects to provide SCE with the Applicants Contract Anticipated Costs, which are subject to refund, that are associated with that portion of the new Distribution Line and/or Service Extension normally installed by SCE, and understands that the lower of SCE's estimated refundable cost or the Applicant's Contract Anticipated Costs, which are subject to refund, as submitted below, shall apply to any applicable SCE refunds and allowances provided in accordance with Rule 15 and 16, 1

**or**

Option 2 Applicant elects not to provide SCE with the Applicants Contract Anticipated Costs, which are subject to refund. The Applicant understands that by selecting this option, the Applicant is directing SCE to use SCE's estimated refundable cost for all billing and accounting.

Applicant understands the Applicants Cost Information, as described above, and hereby elects the following by **initialing** the appropriate selection below :

\_\_\_\_\_ Option 1 - Applicants Contract Anticipated Costs \$ \_\_\_\_\_

\_\_\_\_\_ Option 2 - SCE's Estimated Refundable Costs \$ \_\_\_\_\_

**5. ITCC**

SCE shall value all trenching, conduit, backfill, street repair, substructures, and encasement, based on SCE's estimate of such items, for the purpose of collecting the applicable governmental taxes (ITCC) on contributions to SCE.

**6. MIXED FUEL NEW CONSTRUCTION PROJECTS**

Effective July 1, 2024, Allowances will not apply to Mixed-Fuel New Construction unless otherwise approved by the Commission in accordance with Decision 22-09-026. Effective January 1, 2025, any work performed associated with a Mixed-Fuel New Construction Distribution Line Extension<sup>2</sup> project will be based on actual installed cost. Estimated costs will initially apply with final actual costs due after project completion. When an Applicant selects the Applicant Installation Option within Rule 15, reimbursable credits for the value of the substructures installed by the Applicant and deeded to SCE will not apply.

**7. UTILITY RESPONSIBILITIES**

Upon receipt of this completed and signed form, SCE shall begin the process of producing the applicable contracts and forms based on the selection made by the Applicant.

---

<sup>1</sup>Excludes the estimated costs of work the Applicant cannot perform, such as, work on or in proximity to, energized equipment.

<sup>2</sup> As defined in Rule 15, a Mixed-Fuel New Construction is a building that uses gas and/or propane in addition to electricity, and has never been used or occupied for any purpose

## 8. SIGNATURE CLAUSE

The signatory hereto represents that they have been appropriately authorized into this contract on behalf of the party for whom they sign.

I declare under penalty of perjury that the foregoing is true and correct

Applicant : \_\_\_\_\_

Corporation, Partnership, or DBA: \_\_\_\_\_

Name of Authorized Individual: \_\_\_\_\_

Applicant's signature: \_\_\_\_\_

Title: \_\_\_\_\_

Date: \_\_\_\_\_



CUSTOMER:DANIEL GRUEZO  
CONTACT:310-697-3214

CITY OF REDONDO BEACH  
2SN – COMM/INDUST M&S UG  
TRANSPLANT 4KV O/O DITMAR SUB

CREW AND CUSTOMER  
TD2275740

CUSTOMER NOTES:

–SET UP PRE–CONSTRUCTION MEETING WITH QUALITY CONTROL INSPECTOR, RON WHITTAKER 310.710.9606

–PROVIDE 3’x3’ WORKING AREA NEAR PANEL PER ESR

–NOTIFY PLANNER 2 MONTHS PRIOR TO WHEN READY FOR PERMANENT POWER TO PULL ANY NECESSARY PERMITS (CHECK PROJECT REQUIREMENTS BOX)

CREW NOTE:

–CITY TO REMOVE METER PANEL CURRENTLY ON 4717788E

–WORK WITH METER REMOVAL

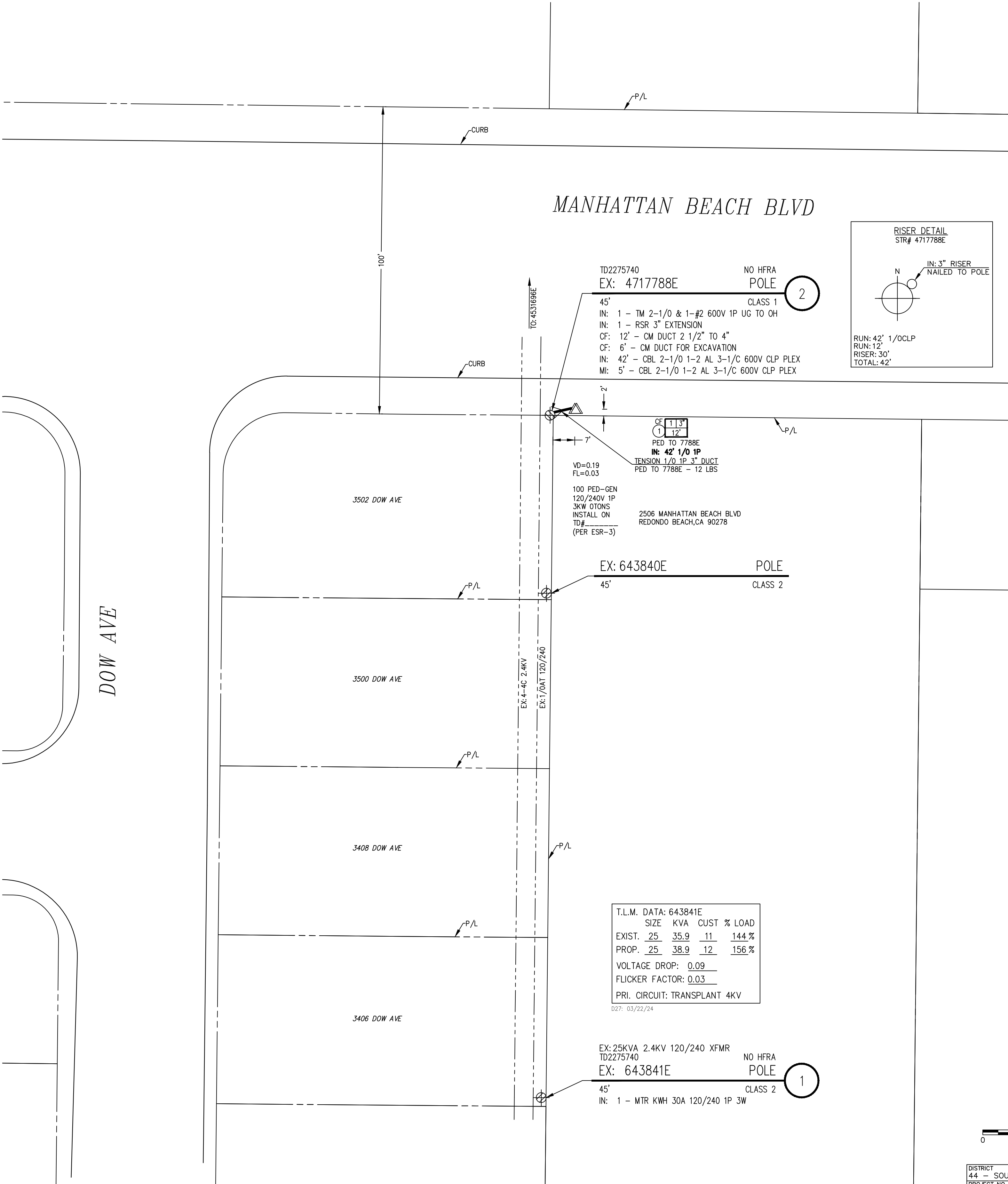

PROJECT REQUIREMENTS (Y/N)	
EDISON EASEMENT REQUIRED	<input type="checkbox"/>
PWRD 88 REQUIRED UG	<input type="checkbox"/>
CIVIL ONLY WORK ORDER	<input type="checkbox"/>
PERMIT REQUIRED	<input type="checkbox"/>
PERMIT TYPE: ENCROACHMENT	
OUTAGE REQUIRED	<input type="checkbox"/>
OUTAGE DATE: TBD	TIME: TBD
TRAFFIC CONTROL REQUIRED	<input type="checkbox"/>
PED. TRAFFIC CONTROL REQ'D	<input type="checkbox"/>
CONVEYANCE LETTER REQ'D	<input type="checkbox"/>
ENVIRONMENTAL REQUIREMENTS DOCUMENT (ERD) REQUIRED	
CSD 140 (TLM) REQ'D	<input type="checkbox"/>
CIRCUIT MAP CHANGE REQ'D (TD 203)	<input type="checkbox"/>
DIG ALERT APP	<input type="checkbox"/>
VERIFIED ACTIVE AND CONFIRMED USA TICKETS	<input type="checkbox"/>
UTILIQUEST NOTIFIED	<input type="checkbox"/>
FAA MARKING REQ'D	<input type="checkbox"/>
FAA TYPE: _____	
STANDARD ADHERENCE: 2ND Q / 2024 - Y	



SCALE: 1" = 20'

FINAL DESIGN  
APPROVED FOR CONSTRUCTION

DISTRICT 44 - SOUTH BAY		PROJ. MGR. MCEVOY, AMANDA GAYLE		PLANNER MCEVOY, AMANDA GAYLE		DESIGNER RODRIGUEZ JR, JUAN CARLOS	
PROJECT NO. 2856209		SERVICE REQUEST 3738317		PHONE 626-260-2630		PHONE 626-260-2630	
CIRCUIT / VOLTAGE TRANSPLANT 4KV		GPS		PRODUCT-1 2275740-NEW METER & SERVICE		ASSOC DESIGN	
SUB / PG NO. DITMAR SUB		CIRCUIT CODE 18100		PRODUCT-2		ASSOC DESIGN	
INVENTORY MAP 044-064D		J.P.A. NO.		PROPOSED CONSTRUCTION (LOCATION)			
				2506 MANHATTAN BEACH BLVD			
				REDONDO BEACH CA 90278			
F 6-19-2024		I KNIGHT		A MCEVOY		JC RODRIGUEZ	
TYPE DATE		APPROVED BY		CHECKED BY		DRAWN BY	
						PAX #	
						SHEET	
						DESIGN/DWG NO.	
						1740884_0.01	

UNDERGROUND SERVICE ALERT  
Contact USA  
Dial 811 or 800-422-4133  
www.digalert.org/contact

WARNING

THE EXCAVATOR MUST TAKE ALL STEPS NECESSARY TO AVOID CONTACT WITH UNDERGROUND FACILITIES WHICH MAY RESULT IN INJURY TO PERSONS OR DAMAGE TO FACILITIES IN THE AREA. THE INDICATED LOCATIONS OF EDISON UNDERGROUND FACILITIES, AS PROVIDED, ARE BELIEVED TO BE ACCURATE. HOWEVER, THE FINAL DETERMINATION OF EXACT LOCATIONS AND THE COST OF REPAIR TO DAMAGED FACILITIES IS THE RESPONSIBILITY OF THE EXCAVATOR.